



APARTMENT 34, THE NEW ALEXANDRA COURT WOODBOROUGH NOTTINGHAM, NG3 4LN

£75,000
LEASEHOLD

Ideal investment opportunity. Tenanted, one bedroom apartment generating a gross yield of 12%

Furnished one double bedroom apartment in this popular development close to the city centre (only 15 minute walk).

This property has an open lounge and kitchen with all appliances, a double bedroom and a spacious shower room with modern suite.

Gated parking included behind electric gates. Additional on-street visitor parking is available.



HOUZLY

Ground Floor
33sq.m / 357.51sq.ft
Approx.

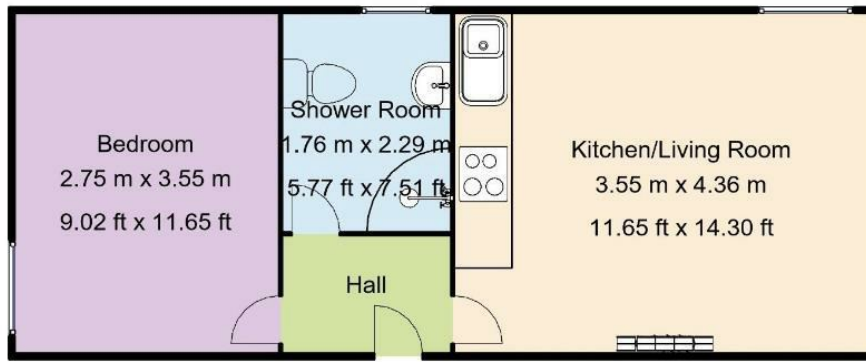

Energy Efficiency Rating		
	Current	Potential
Very energy efficient - lower running costs		
(92 plus) A		
(81-91) B		
(69-80) C		
(55-68) D		
(39-54) E		
(21-38) F		
(1-20) G		
Not energy efficient - higher running costs		
England & Wales	EU Directive 2002/91/EC	

Agents Note: Whilst every care has been taken to prepare these particulars, they are for guidance purposes only. All measurements are approximate and are for general guidance purposes only and whilst every care has been taken to ensure their accuracy, they should not be relied upon and potential buyers/tenants are advised to recheck the measurements

Main Branch
363 Nuthall Road
Nottingham
Nottinghamshire
NG8 5BU

01159789843
sales@houzly.co.uk



HOUZLY